

CONSTRUCTION
UNITS: 87 (303 units total and 242 parking required)

PARKING: UNDERCROFT = 226
 BASEMENT = 255
 SURFACE = 29
 TOTAL = 510
 SURPLUS = 267

RATIO: 0.8

DECANT SECURE : 41 UNITS DEMOLISHED : 128 UNITS REMAIN : 305

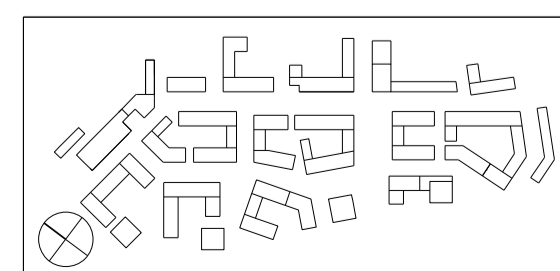

Do not scale from this drawing. Use figured dimensions only. Figured dimensions are in millimetres. All levels are in metres. All dimensions and levels shall be verified on site before proceeding with works. Detailed site survey to be carried out to verify positions and level relationships with site features and ordinance survey. The architect must be notified of any discrepancy. Where building components are described in the specification as contractor designed, "construction" information relating to those components on this drawing represents design intent only.

LEGEND	
	Existing Sewer Line
	Sssi No Build Zone
	Planning Application Line
	Hoarding Line
	Catalyst Site
	Phasing Boundary
	Affordable Units
	Units to be demolished following decant

REV	DATE	DESCRIPTION	OXD	REV	DATE	DESCRIPTION	OXD
P1	15.02.2013	Planning Application Issue	MC				

Allies and Morrison
 85 Southwark Street
 London SE1 0HK
 020 7921 0100
 020 7921 0101
 info@alliesandmorrison.co.uk
 telephone
 facsimile
 email
 A&M JOB NO: 716

WEST HENDON MASTERPLAN
 SITE PLAN
 PHASE 3B
 716_00_07_023
 SCALE: 1:1000 @A1 1:2000 @A3